

DECLARATION OF PERFORMANCE

Declaration number: 104/BG R10-8 CL/11/25



1. Unique identification code of the product-type:

Glass pavers type F, intended to be used in building and construction works. (Welded glass paver.)

2. Type, batch or serial number or any other element allowing identification of the construction product as required under Article 11 (4):

Clear BG R10-8 CLEARVIEW (Dimensions: Ø100mm x 82mm, Weight: 0,86 kg)

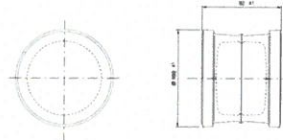

3. Intended use or uses of the construction product, in accordance with applicable harmonized technical specification, as foreseen by the manufacturer:

Use for building of bearing constructions. (Horizontal panels.)

4. Name, registered trade name or registered trademark and contact address of the manufacturer as required pursuant Article 11 (5):

Seves Glass Block s.r.o. - Bilinská 782/42, Duchcov, 419 14, Czech Republic

5. Where applicable, name and contact address of the authorized representative whose mandate covers the tasks specified in Article 12 (2):

Petr Králík - General Director

Seves Glass Block s.r.o. - Bilinská 782/42, Duchcov, 419 14, Czech Republic

6. System or systems of assessment and verification of constancy of performance of the construction product as set out in Annex V:

System 3.

7. In case of the declaration of performance concerning a construction product covered by a harmonized standard:

According to European commission for construction products No. 305/2011, Seves Glass Block s.r.o. declares that the construction product is in conformity with standard stated by harmonized norm EN 1051-1:2003. The product complies with the declared performance and is safe for the intended use as specified in point 3. The evaluation of conformity was performed according to EN 1051-2:2007.

8. Declared performance:

Essential characteristic	Performance	Harmonized technical specification
Reaction on fire	Euro class A1	EN 13501-1:2003; 96/603/EC, 2000/605/EC
Fire resistance class	NPD	EN 13501-2:2016
Bullet resistance	NPD	EN 1522:2000
Explosion resistance	NPD	EN 13541:2012
Burglar resistance	NPD	EN 356:2000
Resistance to temperature differences	NPD	EN 1051-2:2007
Mechanical resistance (compressive strength)	68 kN	EN 1051-1:2003; L 1139
Sound insulation	46,5 (-1,1 ; -3,7) dB	EN 717-1:2020; Č 1018,3
Thermal insulation (U)		EN 673:2011; L 1139
Downwards heat flow	2,3 Wm ⁻² K ⁻¹	
Upwards heat flow	3,3 Wm ⁻² K ⁻¹	
Light transmission	66%	EN 410:2011; L 1139
Solar energy characteristics (g):		EN 410:2011; L 1139
Downwards heat flow	69%	
Upwards heat flow	70%	

NPD = No Performance Determined

9. The performance of the product identified in points 1 and 2 is in conformity with the declared performance in point 8:

This Declaration of Performance is issued under the sole responsibility of the manufacturer identified in point 4.

Signed for and on behalf of the manufacturer:

.....
Petr Králík - General Director

In Duchcov (Czech Republic) on November 24, 2025

Seves Glass Block s.r.o.
Duchcov

